

THE  
ROW  
SAADIYAT

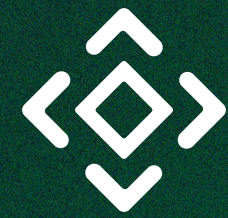



LIVE FRONT ROW



A couple in elegant attire walks through a modern, landscaped courtyard. The woman is wearing a light green, long-sleeved, high-waisted dress with a matching jacket, and the man is wearing a brown blazer over a light-colored shirt and trousers. They are walking on a paved path that curves around a building with large glass windows. Inside the building, several people are seated at tables, dining. The courtyard is lush with greenery, including palm trees and various plants. A small pond with lily pads and pink flowers is visible in the foreground. The scene is bathed in warm, golden light, suggesting late afternoon or early morning.

# LUXURY LIVING IN THE HEART OF SAADIYAT CULTURAL DISTRICT

The Row Saadiyat is where life unfolds like a stage. An iconic address where architecture, well-being, and culture play side by side. Steps from inspiration and expression at every turn, framed by prestigious art and history museums, home to unique design concepts and experiences. This is life curated for the finest.



## ALDAR: ENVISIONING A CULTURAL ICON

As one of the most trusted and recognised real estate lifestyle developers in the UAE, Aldar believes in shaping destinations where culture, design, and daily life converge. With The Row Saadiyat, we're elevating the pulse of Abu Dhabi's Saadiyat Cultural District, a destination fast emerging as a new global centre for culture. Blending vibrancy and refinement in perfect balance, this new lifestyle district redefines modern, inspired living.

# ABU DHABI: A CITY DEFINED BY INSPIRATION AND INNOVATION

Abu Dhabi unites the depth of heritage with the drive of ambition. With its globally renowned landmarks and ever-expanding creative energy, it is at the forefront of culture, design, and business. Home to a rich tapestry of traditions and a modern cosmopolitan spirit, the city reflects the nation's past while shaping its future. Abu Dhabi is not a spectator on the global stage, but a city ready to define it.





# A UNIQUE CONSTELLATION OF CULTURE & CONNECTION

More than a destination, Saadiyat Cultural District is a living dialogue between art and architecture, bringing together the world's most influential voices in culture and design. Offering one of the highest concentrations of cultural experiences, Saadiyat Cultural District is home to Louvre Abu Dhabi, Berklee Abu Dhabi and teamLab Phenomena Abu Dhabi, and the future home of Zayed National Museum, Guggenheim Abu Dhabi and Natural History Museum Abu Dhabi, which sit alongside elite residences, blending luxury and community into one dynamic ecosystem. Here, culture flows seamlessly into daily life, transforming every moment into a story worth telling.

THE  
ROW  
SADIYAT



WHERE ARCHITECTURE,  
WELL-BEING,  
AND CULTURE MEET

GUGGENHEIM ABU DHABI  
1.1 KM  
13 MINUTES

LOUVRE ABU DHABI  
1.1 KM  
13 MINUTES

MAMSHA AL SAADIYAT  
360 M  
4 MINUTES

# THE ROW SAADIYAT

ZAYED NATIONAL MUSEUM  
600 M  
7 MINUTES

NATURAL HISTORY MUSEUM  
1 KM  
12 MINUTES

TEAMLAB PHENOMENA  
1 KM  
12 MINUTES



Perfectly positioned within Saadiyat Cultural District, The Row Saadiyat sits just steps from the capital's most inspiring landmarks, offering a life seamlessly connected to culture, calm, and the coast.



A LIVING GALLERY  
OF TASTE AND ART

At The Row Saadiyat, life unfolds just beyond your doorstep. Global lifestyle brands and experiences come together to create an exclusive boutique village. A curated collection of immersive fine-dining, concept cafes and retail, and wellness amenities transforms the district into a home like no other.

A man in a white thobe and ghutra stands in a modern, brightly lit interior space. The background features a wall of shelves filled with numerous small, dark bottles, possibly perfume or skincare products. The lighting is warm and focused on the man, creating a serene and sophisticated atmosphere.

## CONNECT & DISCONNECT EFFORTLESSLY

Discover a place where life finds its balance. Below, lively cafés, boutiques and galleries invite you to connect with culture and community. Above, serene residences offer a private sanctuary to pause and recharge. Here, you can be part of the world, and step away from it when you wish.

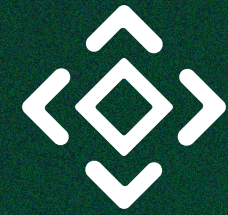

AMENITIES



# THE OTHER SPACE

*THE ART OF GATHERING*

At the heart of the district lies The Other Space, a signature, boutique communal hub designed exclusively for residents. This flexible venue, complete with a shared kitchen for pop-ups and private events, offers a warm and inspiring setting for creativity to flourish. Art-house interiors and a sophisticated yet approachable palette create an atmosphere where emerging and established ideas meet, making it a living canvas for connection and community.



# CURATED KIDS' CLUBS

*A PLAYGROUND FOR IMAGINATION*

Curated Kids' Clubs have been designed with child development experts to inspire curiosity, creativity, and purposeful play. Thoughtfully crafted environments encourage learning through exploration, giving every child space to imagine, create, and grow in their own way.





# THE WELLNESS POD

*THE QUIET LUXURY OF PAUSE*

The Wellness Pod is a serene retreat designed to restore balance and clarity. Blending contemporary design and state-of-the-art treatments with a sense of quiet refinement, it offers residents a space to unwind, reflect, and reconnect.

## AMENITIES

---

TWO LAGOON POOLS

---

PET SPA AND GROOMING

---

CO-WORKING LOUNGES

---

CO-WORKING MEMBERS CLUB

---

GOURMET SUPERMARKET

---

BOUTIQUE RETAIL STORES

---

BOUTIQUE FITNESS STUDIOS

---

GOURMET CAFÉS AND RESTAURANTS

---



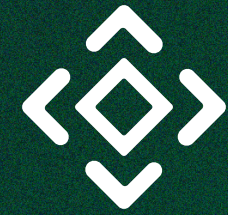

BUILDING DESIGN





## WHERE THE ROW RISES

Seven striking buildings shape The Row Saadiyat, where form meets feeling to deliver a boutique village lifestyle. Designed by the world-renowned Bjarke Ingels Group, the modern architecture flows seamlessly between indoors and out, blending greenery, shade, and light. From one to three-bedroom residences, each space reflects a human approach: sophisticated yet playful, urban yet connected to the world.

THE ARCHITECT

ARCHITECTURE  
THAT INSPIRES  
& ENDURES

Named one of TIME's 100 Most Influential People, Bjarke Ingels leads the world-renowned **Bjarke Ingels Group**. This multidisciplinary studio works at the intersection of architecture, urbanism, landscape, and systems thinking. Known for landmark creations such as the hybrid pyramid-courtyard of VIA 57 West in Manhattan and the skiable waste-to-energy plant CopenHill in Copenhagen, BIG reimagines how people live within cities. Their philosophy proposes that sustainability and pleasure can coexist and that the best environments are not only responsible, but deeply enjoyable to inhabit.



“IN THE BIG PICTURE, ARCHITECTURE IS THE  
ART AND SCIENCE OF MAKING SURE THAT  
OUR CITIES BUILDINGS FIT WITH THE WAY WE  
WANT TO LIVE OUR LIVES.”

– BJARKE INGELS



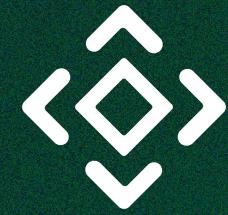

# APARTMENT DESIGN





## HOMES THAT REFLECT YOUR RHYTHM

Interiors by **Kettle Collective** bring artistry and intention to everyday life. Designed through collaboration and crafted with purpose, each space reflects a dialogue between elegance, function, and ease. Materials, textures, and light are composed in perfect harmony, creating an environment that feels grounded yet uplifting.



Thoughtfully designed with intelligent storage, premium built-ins, and refined details that make every daily ritual feel effortless.

THE INTERIOR DESIGNER

## TAILORED INTERIORS, TIMELESS APPEAL

Passionate architects, designers, engineers and thinkers unite at **Kettle Collective** to bring a singular level of intent to interior design. Their work is rooted in both commitment to excellence and innovation. Each space is conceived to integrate seamlessly into everyday life. With meticulous attention to detail, they move beyond trends to create lasting environments where architecture and harmony converge. Here, design becomes more than aesthetics; it connects people, places and purpose in an elevated, meaningful way.



“WE CREATE ENVIRONMENTS THAT ARE NOT ONLY FUNCTIONAL BUT ALSO INSPIRE AND UPLIFT THOSE WHO EXPERIENCE THEM.”

– MARTA GROSOLI



A space of quiet sophistication, featuring subtle lighting that elevates comfort with considered elegance.





A serene blend of form and function, where crafted fittings and elegant materials create a calm sense of renewal.



## MATERIALS & FINISHES



GENERAL FLOOR  
PORCELAIN TILE  
*HERRINGBONE*

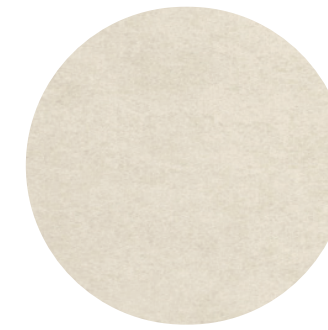

BATHROOM FLOORING  
AND WALLS  
PORCELAIN TILE

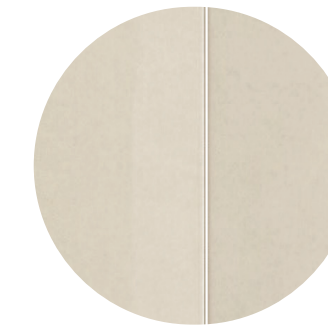

BATHROOM  
FEATURE WALL  
CERAMIC TILE

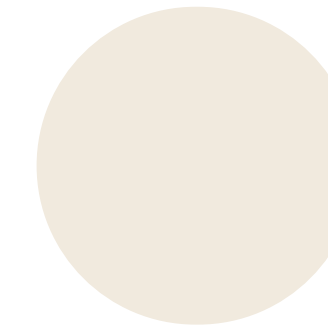

KITCHEN CABINET  
& WARDROBE  
LAMINATE



WALLS  
AND CEILING  
PAINT



BEDROOM  
FLOOR  
ENGINEERED WOOD



INTERNAL  
DOOR  
LAMINATE



ENTRANCE  
DOOR  
VENEER

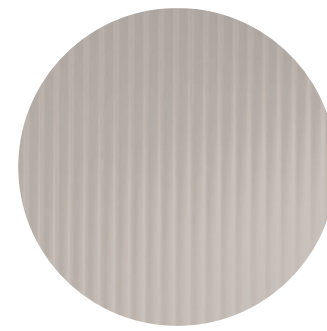

SHOWER, WARDROBE &  
KITCHEN CABINETS  
TINTED GLASS



KITCHEN ISLAND  
& VANITY  
ENGINEERED STONE

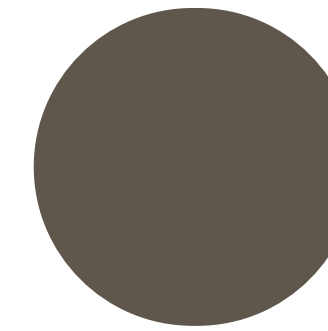

SANITARYWARE  
MATT GUN METAL

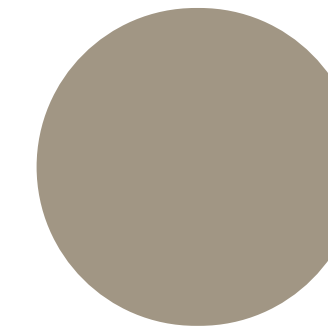

WASH BASIN  
CERAMIC

A harmonious palette of warm tones, complemented by rich, tactile finishes. Natural textures from polished timber floors to sun kissed cabinetry bring timeless elegance and understated refinement to every space.

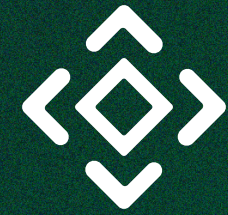

# FLOOR PLANS



ONE BEDROOM  
TYPE A/1 | TYPICAL



ONE BEDROOM  
TYPE A/1 | NON-TYPICAL



ONE BEDROOM  
TYPE C / 1 | NON-TYPICAL



ONE BEDROOM  
TYPE C / 2 | NON-TYPICAL



ONE BEDROOM  
TYPE D / 1 | NON-TYPICAL



ONE BEDROOM  
TYPE D / 2 | NON-TYPICAL

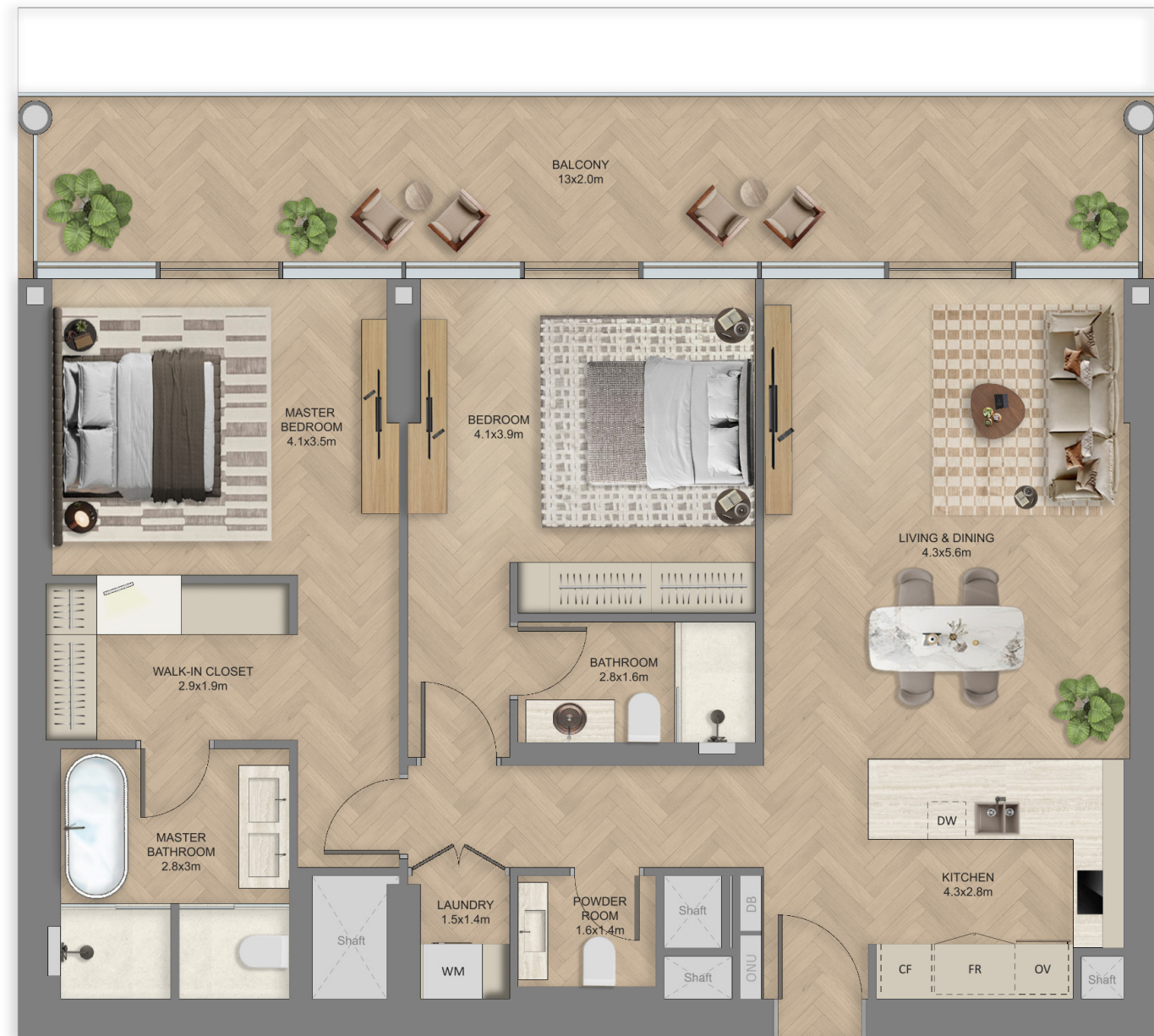

TWO BEDROOM  
TYPE A/1 | TYPICAL



TWO BEDROOM  
TYPE A/1 | NON-TYPICAL



TWO BEDROOM  
TYPE C / 1 | NON-TYPICAL



TWO BEDROOM  
TYPE C / 2 | NON-TYPICAL



TWO BEDROOM  
TYPE C / 3 | NON-TYPICAL



TWO BEDROOM  
TYPE C / 4 | NON-TYPICAL



TWO BEDROOM  
TYPE C / 5 | NON-TYPICAL



TWO BEDROOM  
TYPE D / 1 | NON-TYPICAL

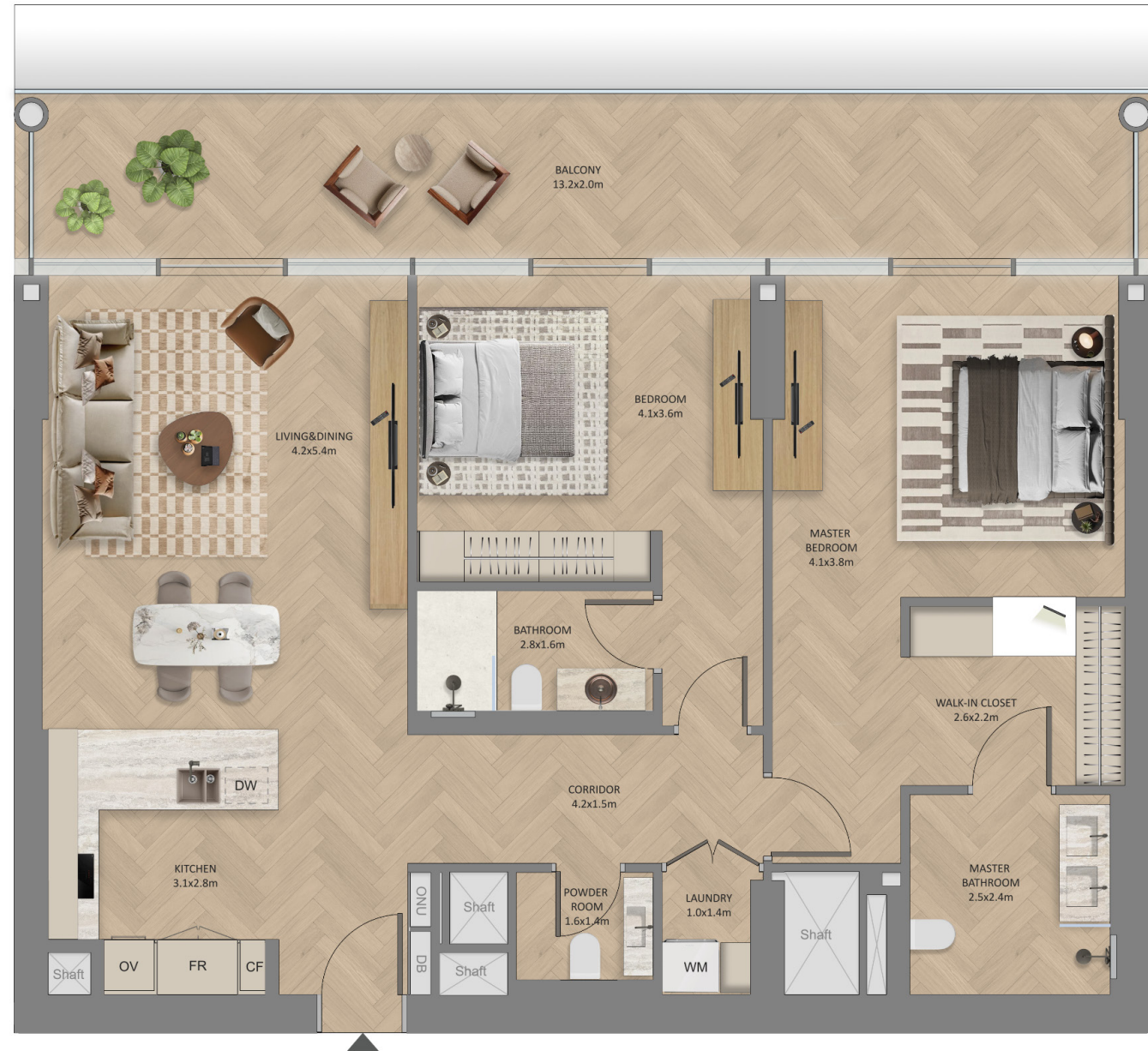

TWO BEDROOM + M  
TYPE D / 1 | NON-TYPICAL

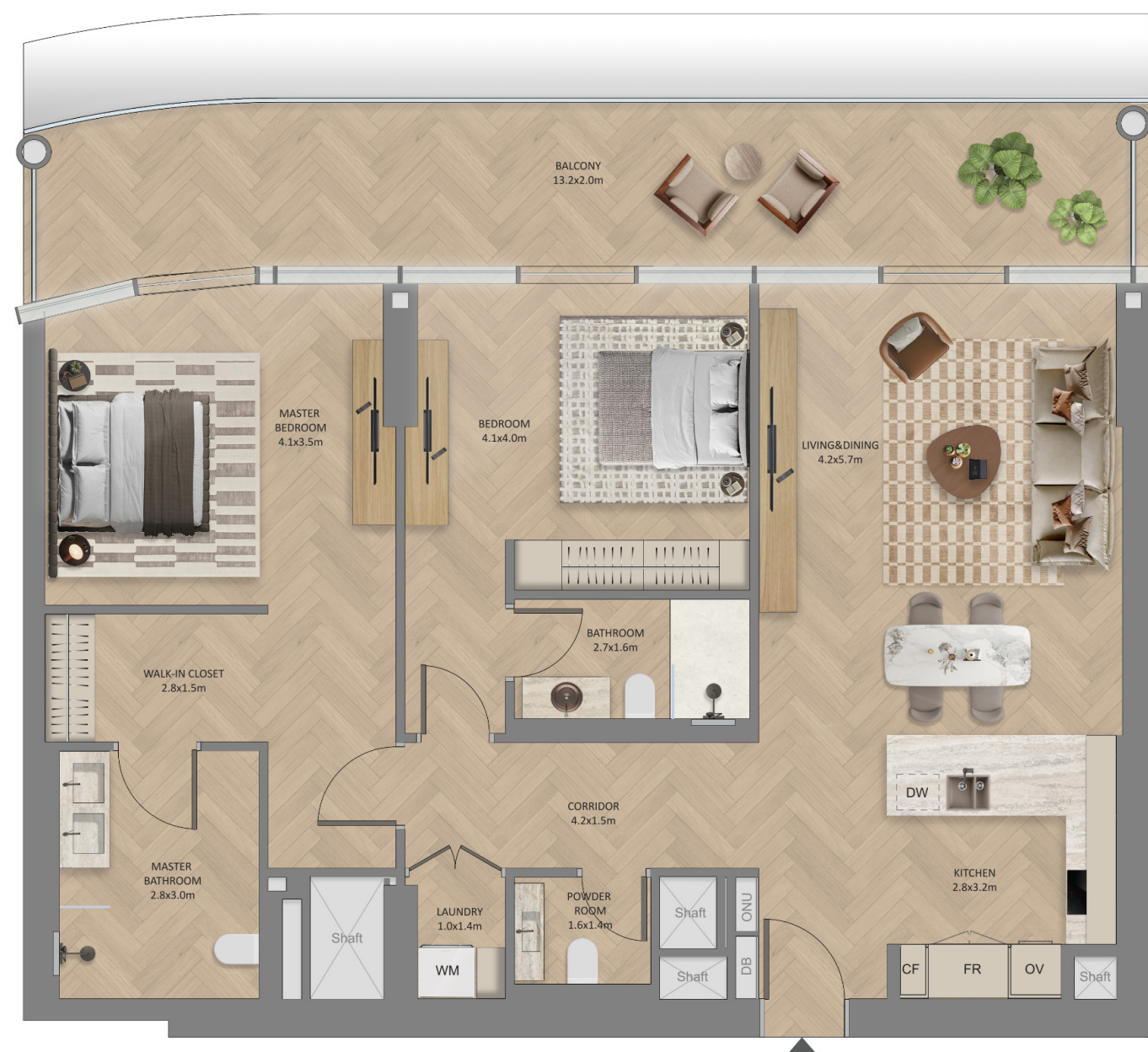

TWO BEDROOM  
TYPE D / 2 | TYPICAL



TWO BEDROOM  
TYPE D / 3 | TYPICAL



TWO BEDROOM + M  
TYPE B / 1 | TYPICAL



TWO BEDROOM + M  
TYPE A / 4 | TYPICAL



TWO BEDROOM + M  
TYPE A / 3 | TYPICAL



TWO BEDROOM + M  
TYPE B / 1 | TYPICAL



TWO BEDROOM + M  
TYPE B / 2 | TYPICAL



TWO BEDROOM + M  
TYPE B / 3 | TYPICAL



TWO BEDROOM + M  
TYPE B / 1 | NON-TYPICAL



TWO BEDROOM + M  
TYPE B / 2 | NON-TYPICAL



THREE BEDROOM + M (LARGE)  
TYPE A / 1 | TYPICAL



THREE BEDROOM + M (LARGE)  
TYPE A / 2 | TYPICAL



THREE BEDROOM + M (LARGE)  
TYPE B / 1 | TYPICAL



THREE BEDROOM + M (LARGE)  
TYPE B / 2 | TYPICAL



THREE BEDROOM + M (LARGE)  
TYPE B / 3 | TYPICAL



THREE BEDROOM + M (LARGE)  
 TYPE A/1 | NON-TYPICAL



THREE BEDROOM + M (LARGE)  
 TYPE C/1 | NON-TYPICAL



THREE BEDROOM + M (LARGE)  
TYPE D / 1 | NON-TYPICAL



THREE BEDROOM + M (LARGE)  
TYPE A / 2 | NON-TYPICAL



THREE BEDROOM + M (LARGE)  
TYPE D / 1 | NON-TYPICAL



THREE BEDROOM + M (LARGE)  
TYPE B / 1 | NON-TYPICAL



THREE BEDROOM + M (LARGE)  
TYPE C / 2 | NON-TYPICAL



THREE BEDROOM + M (LARGE)  
TYPE B / 2 | NON-TYPICAL



THREE BEDROOM + M (LARGE)  
TYPE B / 3 | NON-TYPICAL

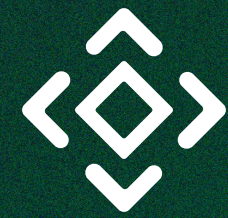

# FLOORPLATES

- 1 BED UNIT
- 2 BED + MAID UNIT
- 3 BED + MAID
- CORRIDOR
- 2 BED UNIT
- 2 BED + MAID + STUDY UNIT
- AMENITIES
- SERVICES



PARK VIEW

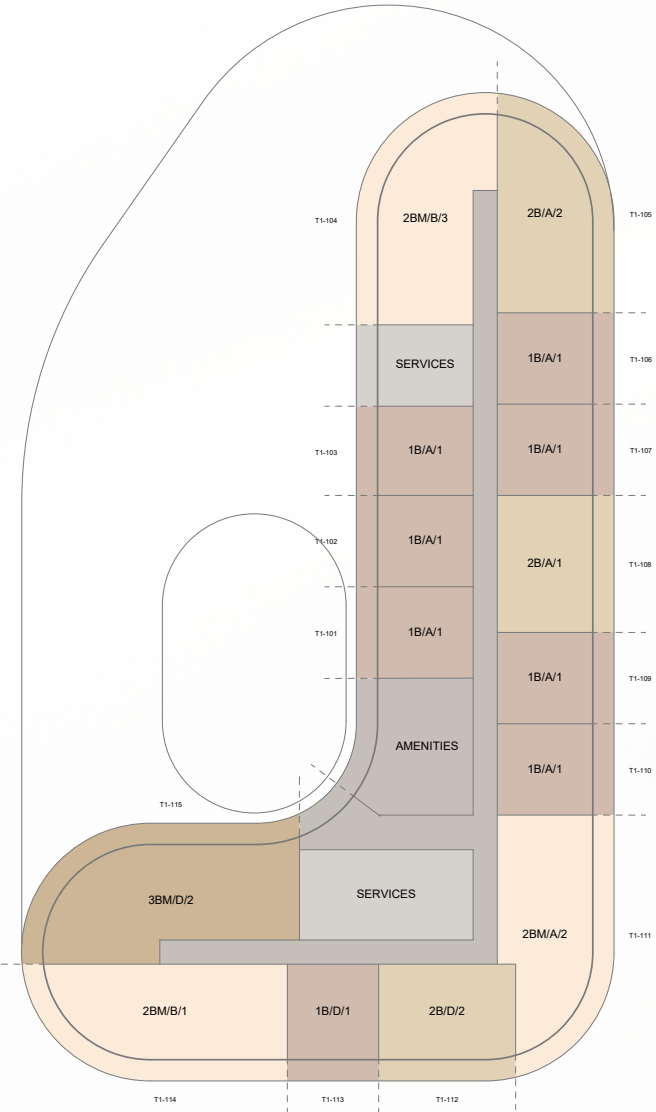

INTERNAL COURTYARD / PODIUM VIEW



PARK VIEW



INTERNAL COURTYARD / PODIUM VIEW



PARK VIEW



ZAYED NATIONAL MUSEUM

THE ROW ONE  
LEVEL 1



PARK VIEW

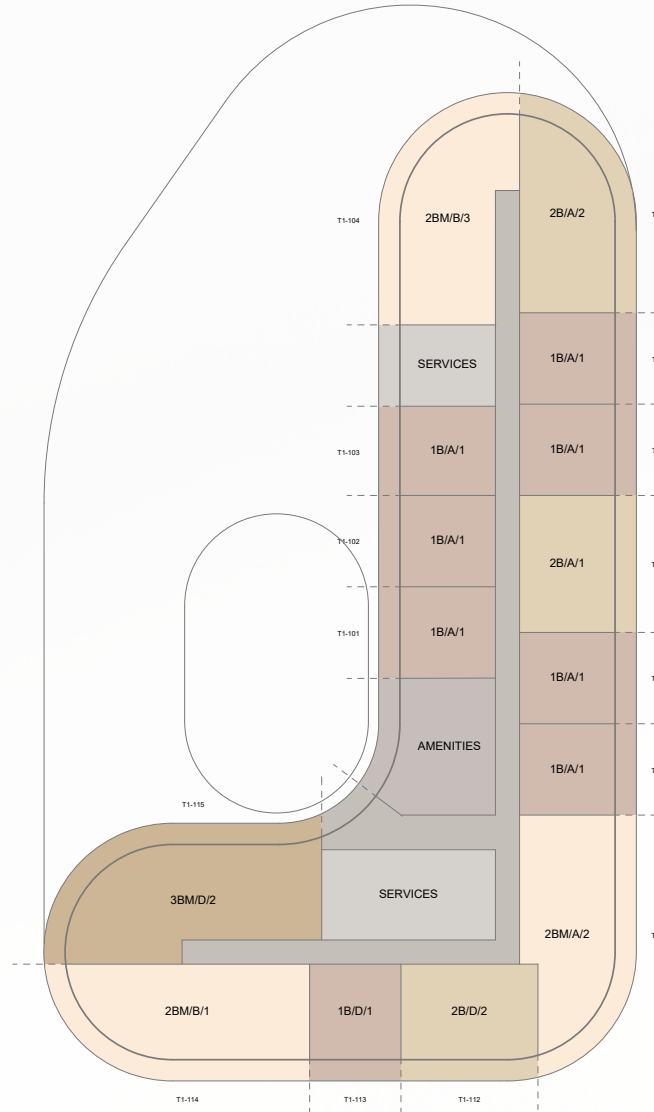

ZAYED NATIONAL MUSEUM

THE ROW ONE  
LEVEL 2

- 1 BED UNIT
- 2 BED + MAID UNIT
- 3 BED + MAID
- CORRIDOR
- 2 BED UNIT
- 2 BED + MAID + STUDY UNIT
- AMENITIES
- SERVICES



PARK VIEW



INTERNAL COURTYARD / PODIUM VIEW

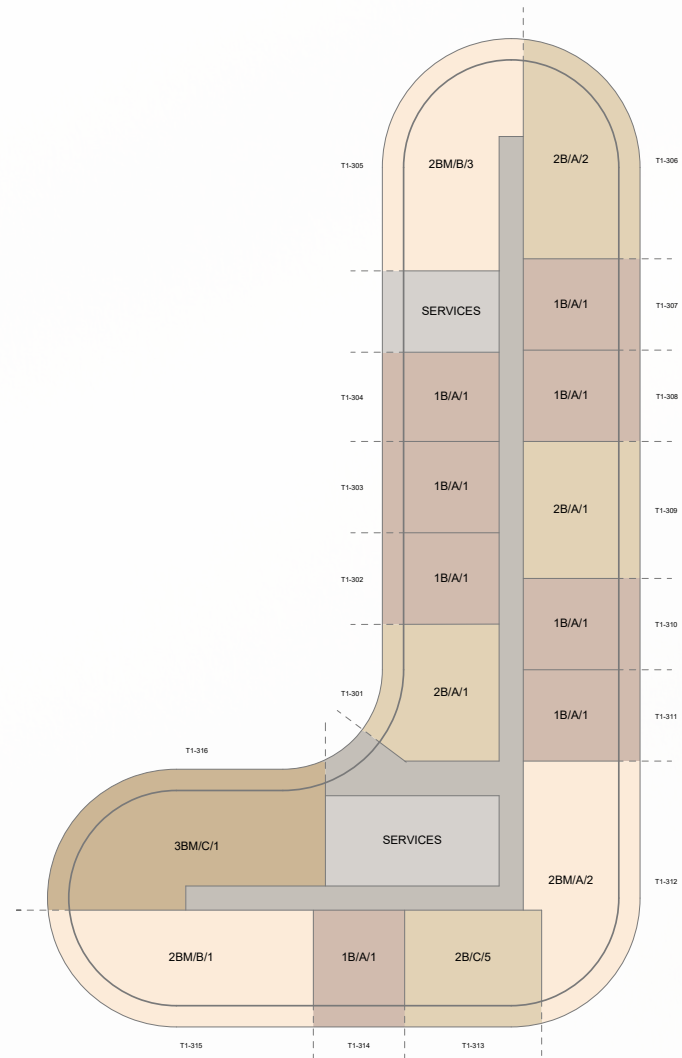

ZAYED NATIONAL MUSEUM

THE ROW ONE  
TYPICAL LEVEL (LEVELS 3-8)



PARK VIEW



INTERNAL COURTYARD / PODIUM VIEW

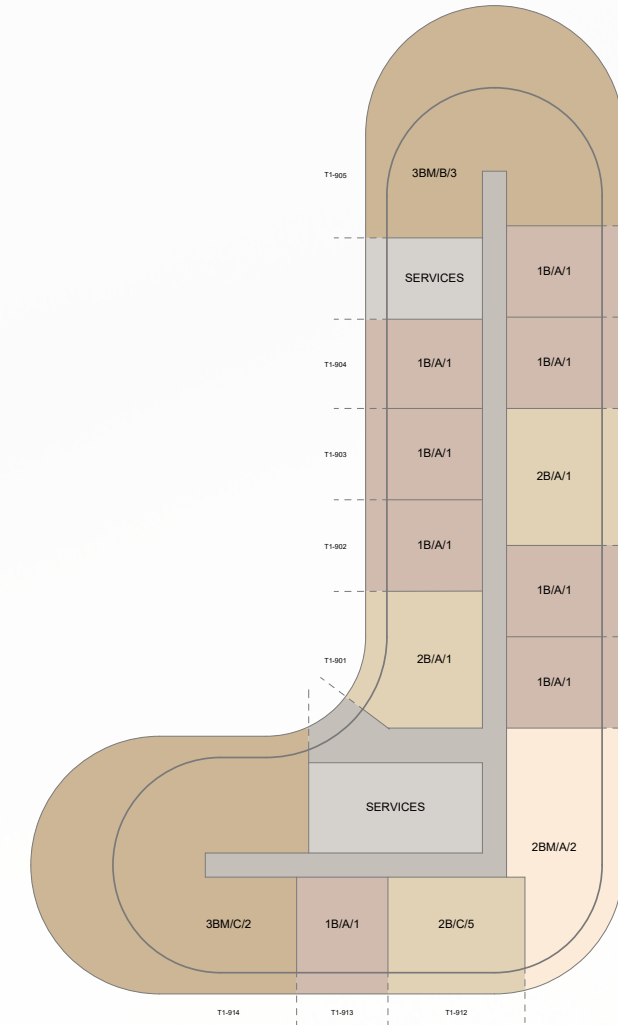

ZAYED NATIONAL MUSEUM

THE ROW ONE  
LEVEL 9



PARK VIEW

- 1 BED UNIT
- 2 BED + MAID UNIT
- 3 BED + MAID
- CORRIDOR
- 2 BED UNIT
- 2 BED + MAID + STUDY UNIT
- AMENITIES
- SERVICES



MOSQUE VIEW

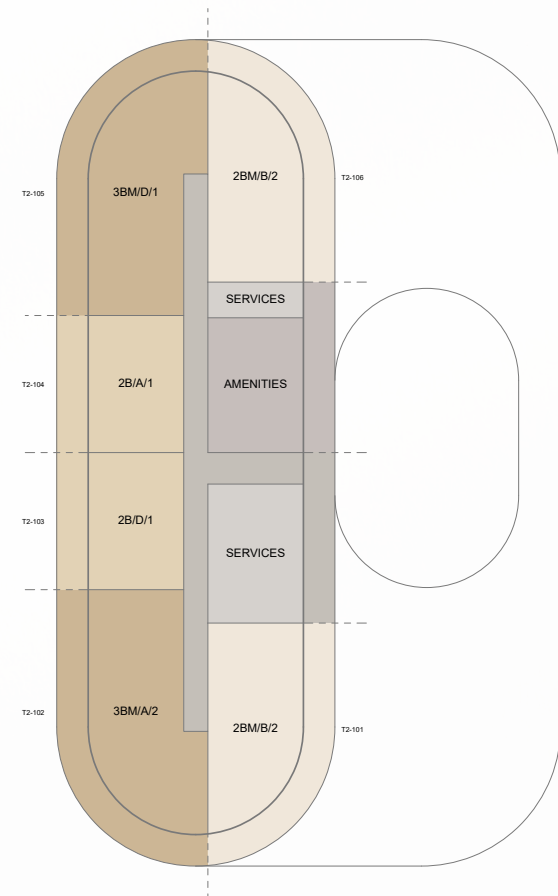

ZAYED NATIONAL MUSEUM

THE ROW TWO  
LEVEL 1



INTERNAL COURTYARD / PODIUM VIEW



PARTIAL ZAYED NATIONAL MUSEUM



MOSQUE VIEW

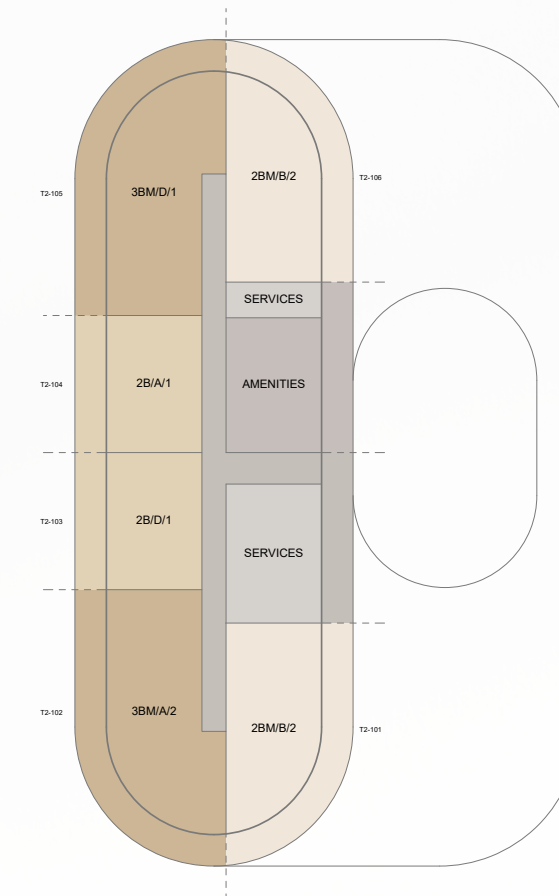

ZAYED NATIONAL MUSEUM

THE ROW TWO  
LEVEL 2



INTERNAL COURTYARD / PODIUM VIEW

- 1 BED UNIT
- 2 BED + MAID UNIT
- 3 BED + MAID
- CORRIDOR
- 2 BED UNIT
- 2 BED + MAID + STUDY UNIT
- AMENITIES
- SERVICES



MOSQUE VIEW



MOSQUE VIEW



PARTIAL ZAYED NATIONAL MUSEUM

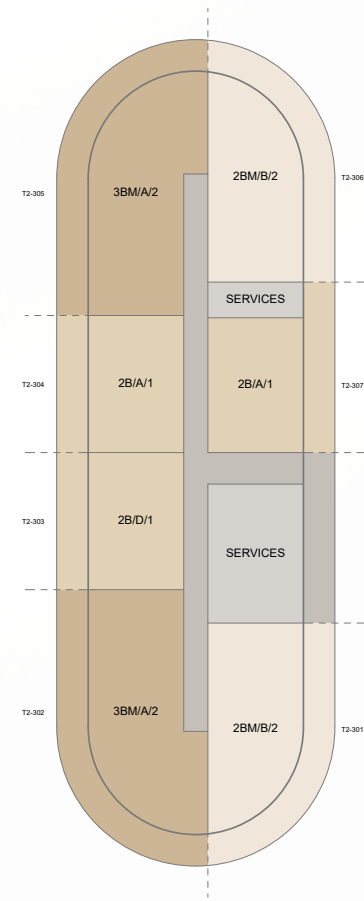

INTERNAL COURTYARD / PODIUM VIEW



MAMSHA AL SAADIYAT

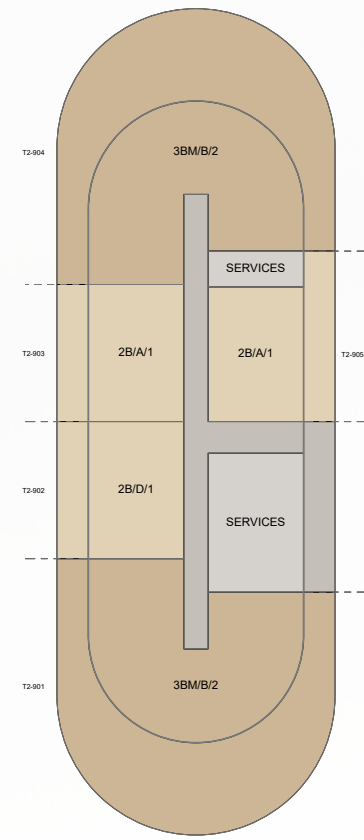

INTERNAL COURTYARD / PODIUM VIEW



ZAYED NATIONAL MUSEUM

THE ROW TWO  
TYPICAL LEVEL (LEVELS 3-8)

THE ROW TWO  
LEVEL 9

- 1 BED UNIT
- 2 BED + MAID UNIT
- 3 BED + MAID
- CORRIDOR
- 2 BED UNIT
- 2 BED + MAID + STUDY UNIT
- AMENITIES
- SERVICES



MOSQUE VIEW

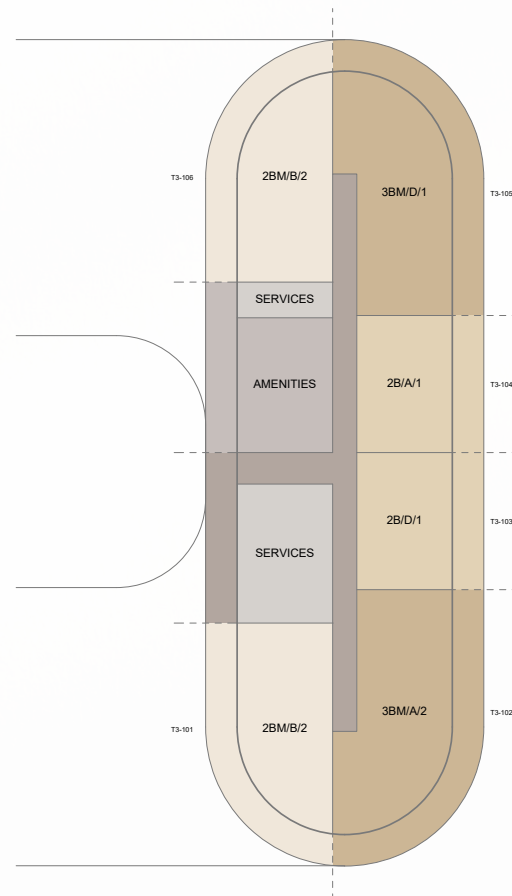

PARTIAL ZAYED NATIONAL MUSEUM



INTERNAL COURTYARD / PODIUM VIEW



PARTIAL ZAYED NATIONAL MUSEUM



ZAYED NATIONAL MUSEUM

THE ROW THREE  
LEVEL 1



MOSQUE VIEW

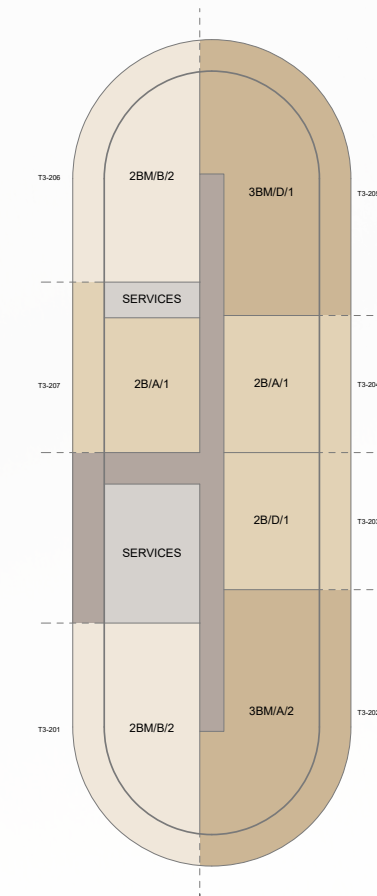

ZAYED NATIONAL MUSEUM

THE ROW THREE  
LEVEL 2

- 1 BED UNIT
- 2 BED + MAID UNIT
- 3 BED + MAID
- CORRIDOR
- 2 BED UNIT
- 2 BED + MAID + STUDY UNIT
- AMENITIES
- SERVICES



MOSQUE VIEW

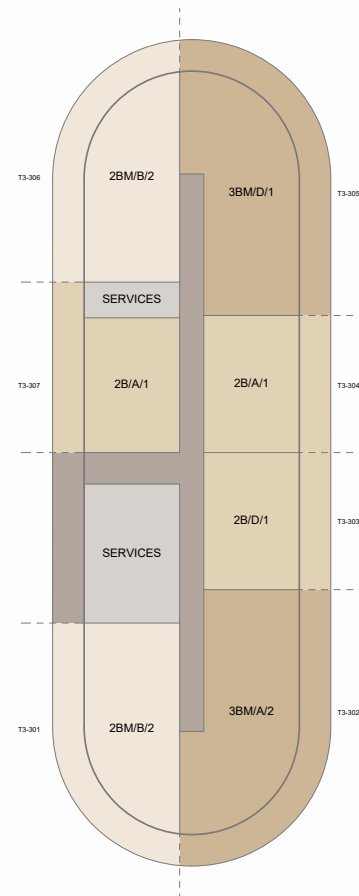

INTERNAL COURTYARD / PODIUM VIEW



PARTIAL ZAYED NATIONAL MUSEUM



INTERNAL COURTYARD / PODIUM VIEW



PARTIAL ZAYED NATIONAL MUSEUM

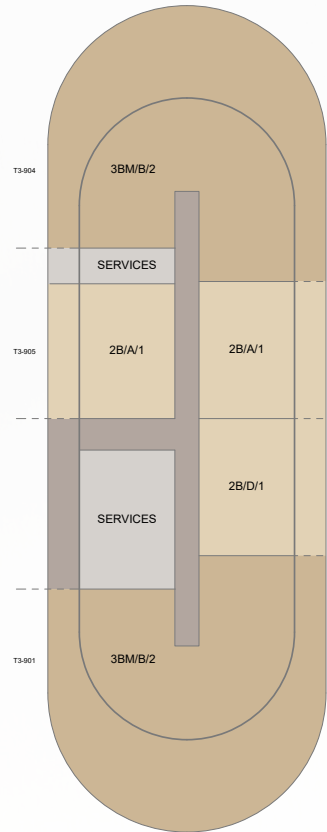

ZAYED NATIONAL MUSEUM

THE ROW THREE  
TYPICAL LEVEL (LEVELS 3-8)

THE ROW THREE  
LEVEL 9

- 1 BED UNIT
- 2 BED + MAID UNIT
- 3 BED + MAID
- CORRIDOR
- 2 BED UNIT
- 2 BED + MAID + STUDY UNIT
- AMENITIES
- SERVICES



INTERNAL COURTYARD  
/ PODIUM VIEW



INTERNAL COURTYARD  
/ PODIUM VIEW

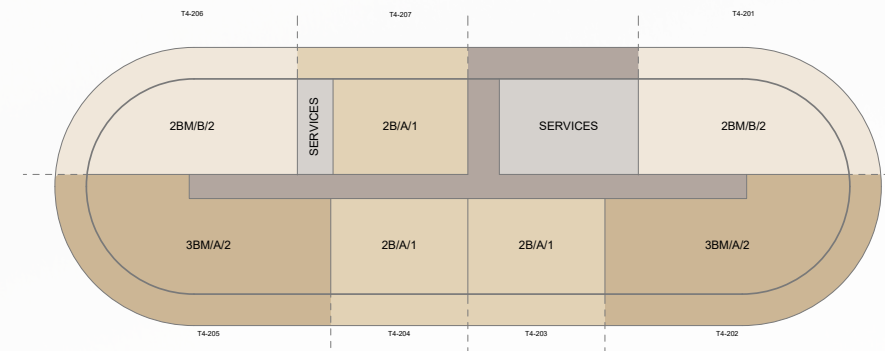
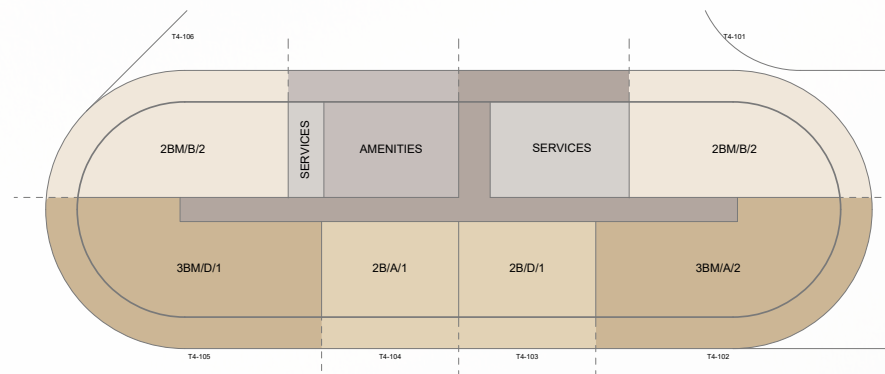

THE ROW FOUR  
LEVEL 1



THE ROW FOUR  
LEVEL 2

- 1 BED UNIT
- 2 BED + MAID UNIT
- 3 BED + MAID
- CORRIDOR
- 2 BED UNIT
- 2 BED + MAID + STUDY UNIT
- AMENITIES
- SERVICES



INTERNAL COURTYARD / PODIUM VIEW



MAMSHA AL SAADIYAT



PARTIAL ZAYED NATIONAL MUSEUM

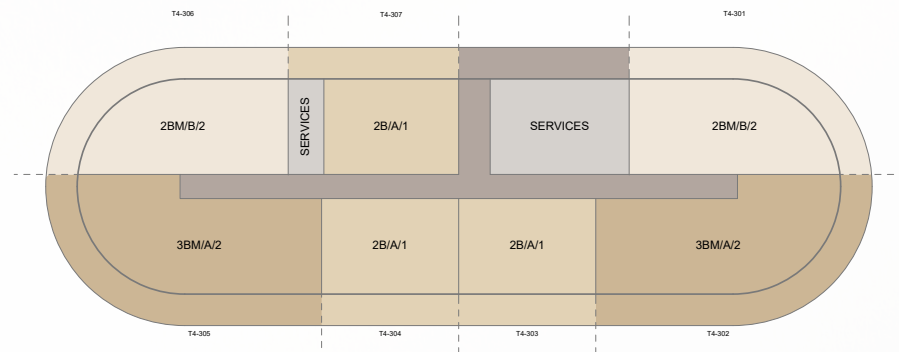

PARTIAL ZAYED NATIONAL MUSEUM



MAMSHA AL SAADIYAT

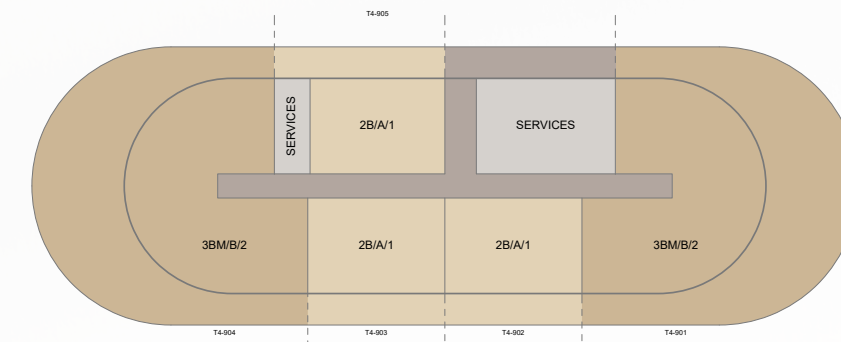

PARK VIEW



ZAYED NATIONAL MUSEUM

THE ROW FOUR  
TYPICAL LEVEL (LEVELS 3-8)



ZAYED NATIONAL

THE ROW FOUR  
LEVEL 9







- 1 BED UNIT
- 2 BED + MAID UNIT
- 3 BED + MAID
- CORRIDOR
- 2 BED UNIT
- 2 BED + MAID + STUDY UNIT
- AMENITIES
- SERVICES



MAMSHA AL SAADIYAT

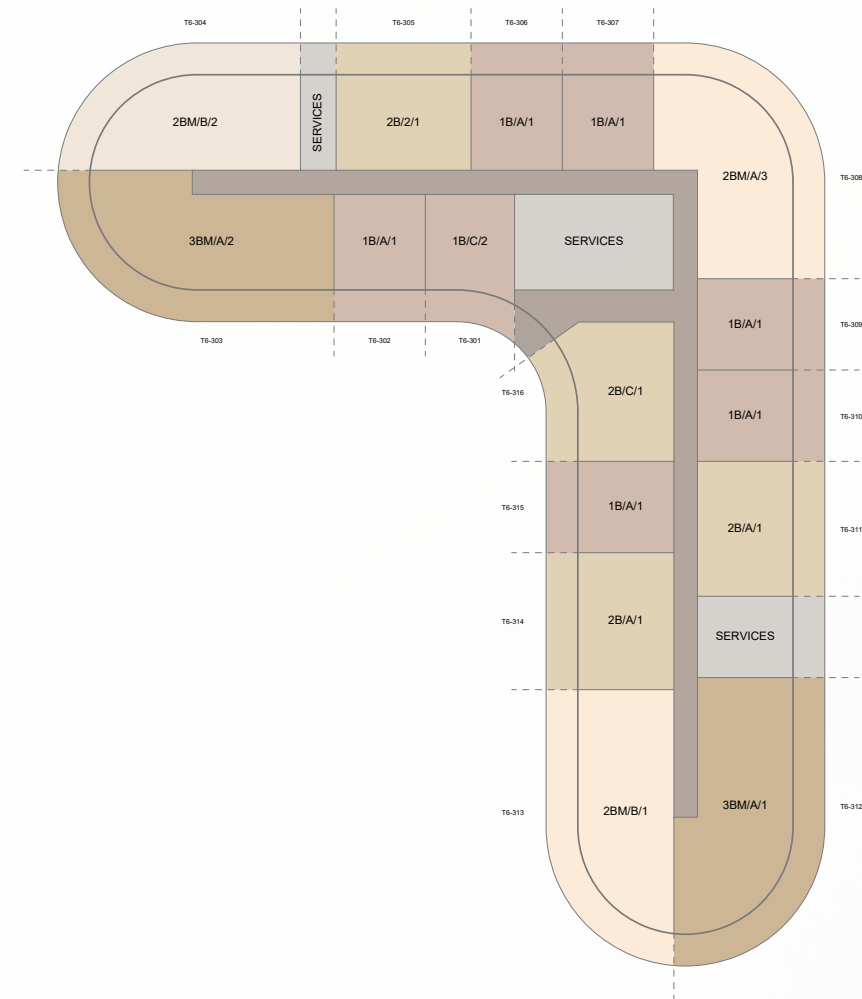

ZAYED NATIONAL MUSEUM



PARK VIEW



ZAYED NATIONAL MUSEUM



PARK VIEW

THE ROW SIX  
TYPICAL LEVEL (LEVELS 3-8)



MAMSHA AL SAADIYAT

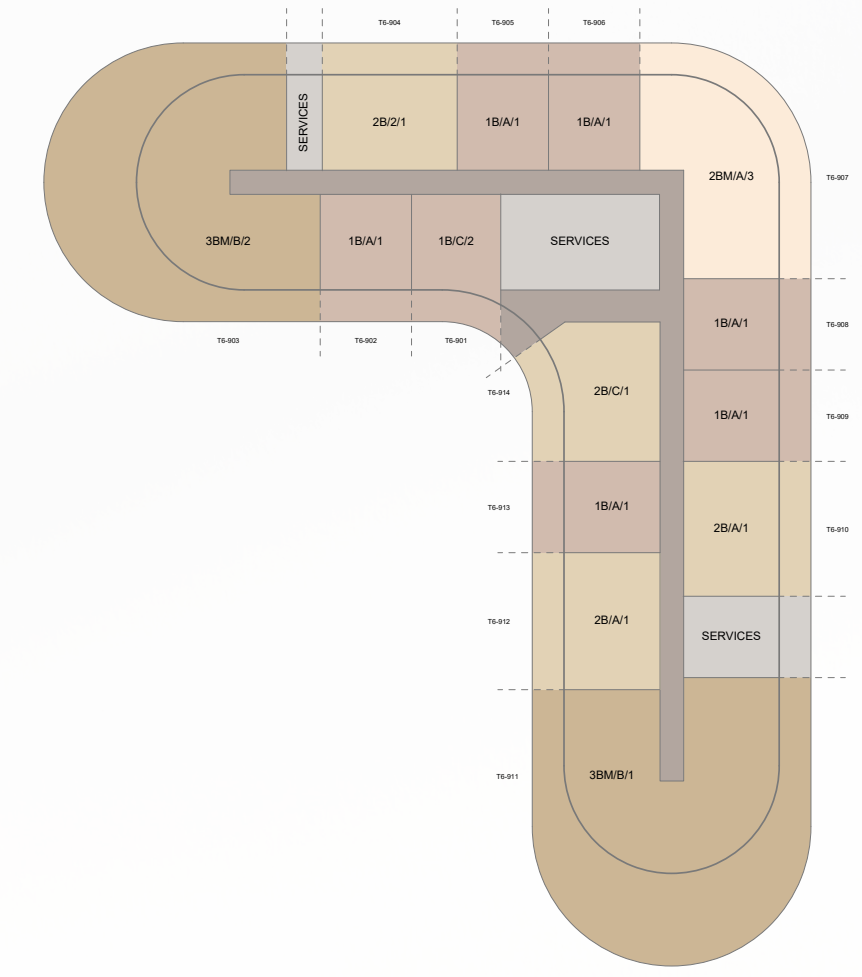

ZAYED NATIONAL MUSEUM

THE ROW SIX  
LEVEL 9

- 1 BED UNIT
- 2 BED + MAID UNIT
- 3 BED + MAID
- CORRIDOR
- 2 BED UNIT
- 2 BED + MAID + STUDY UNIT
- AMENITIES
- SERVICES



PARK VIEW

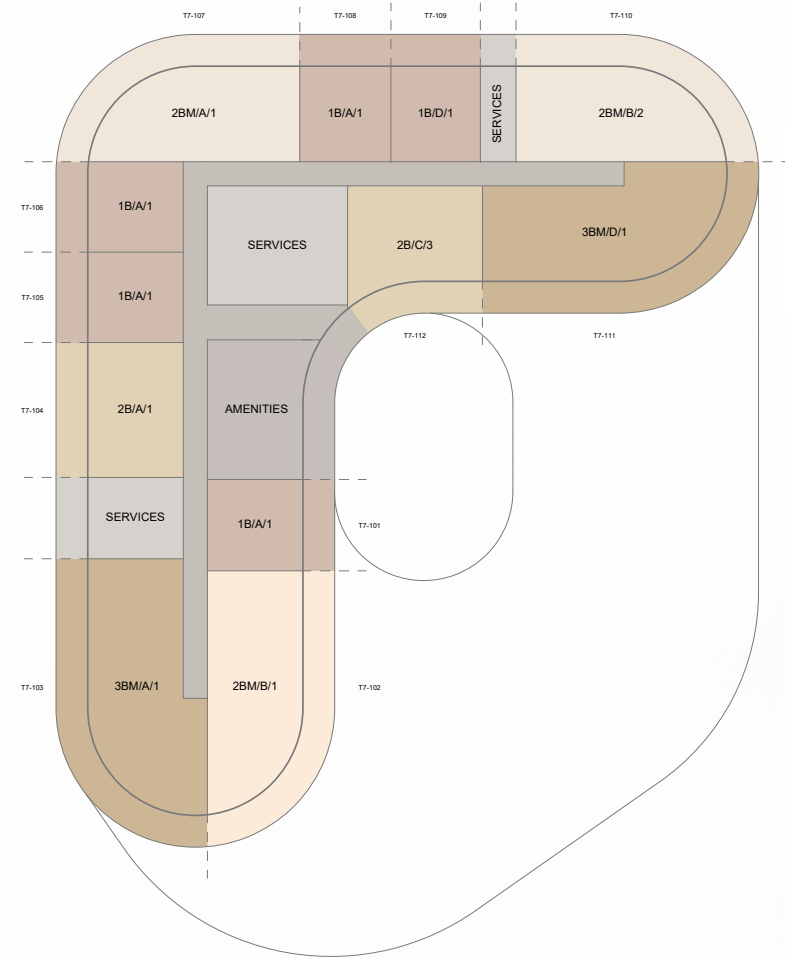

MAMSHA AL SAADIYAT



ZAYED NATIONAL MUSEUM



ZAYED NATIONAL MUSEUM

THE ROW SEVEN  
LEVEL 1



PARK VIEW

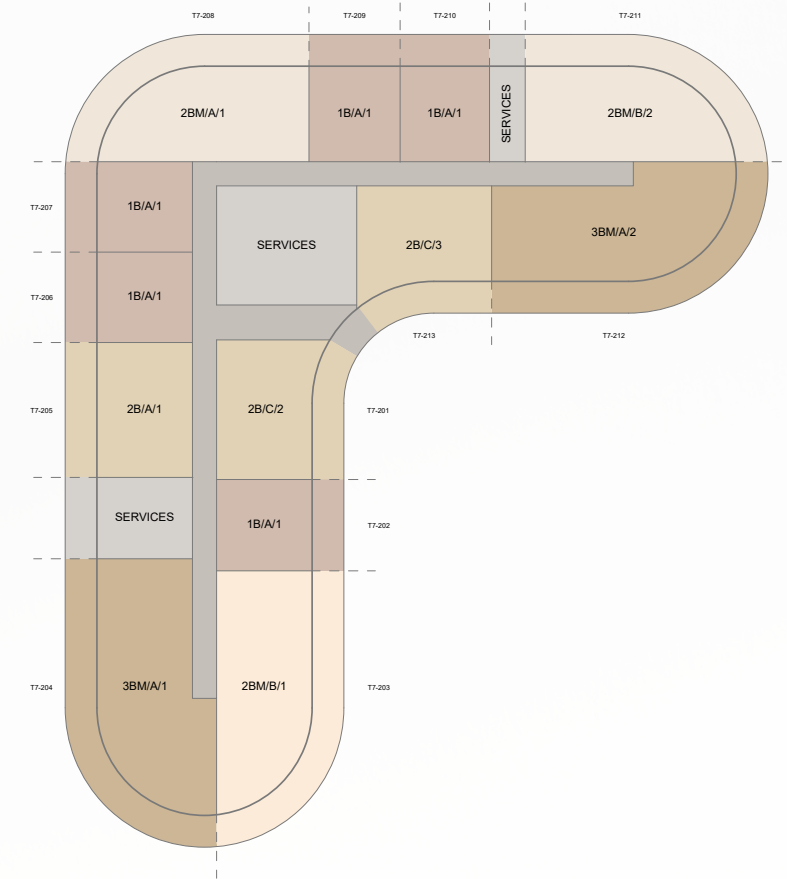

MAMSHA AL SAADIYAT



ZAYED NATIONAL MUSEUM



ZAYED NATIONAL MUSEUM

THE ROW SEVEN  
LEVEL 2



THE  
ROW  
SAADIYAT

